

© 1968 BY AMP INCORPORATED. ALL RIGHTS RESERVED. AMP PRODUCTS COVERED BY PATENTS AND/OR PATENTS PENDING.

THIS PRODUCT DESIGNED AND BUILT BY AMP INCORPORATED. NO LICENSE TO USE THAT DESIGN IN MANUFACTURE, OR TO USE ANY ISSUED OR PENDING PATENTS WHICH ARE INVOLVED, IS IMPLIED.

REVISIONS				
ZONE	LTR	DESCRIPTION	DATE	APPROVED
—	—	REF. SD #26272		
	A	REVISED NOTE 1	LAB 10-18-73	JPA
	B	REVISED PER ECN 4349	D.S. 5-22-74	M.A.
	C	REVISED	RNL 4/7/72	M.A.
	D	REMOVED O-RING GROOVE ECN B355 R.G.R.	8-14-78	M.A.
	E	REV PER ECN S-3960	9/20/87	R.S.
	F	OBS-2 ECN DF 0376	ZP 2-89	T.W.
	G	REV PER OH14-0192-05	1-06	PY

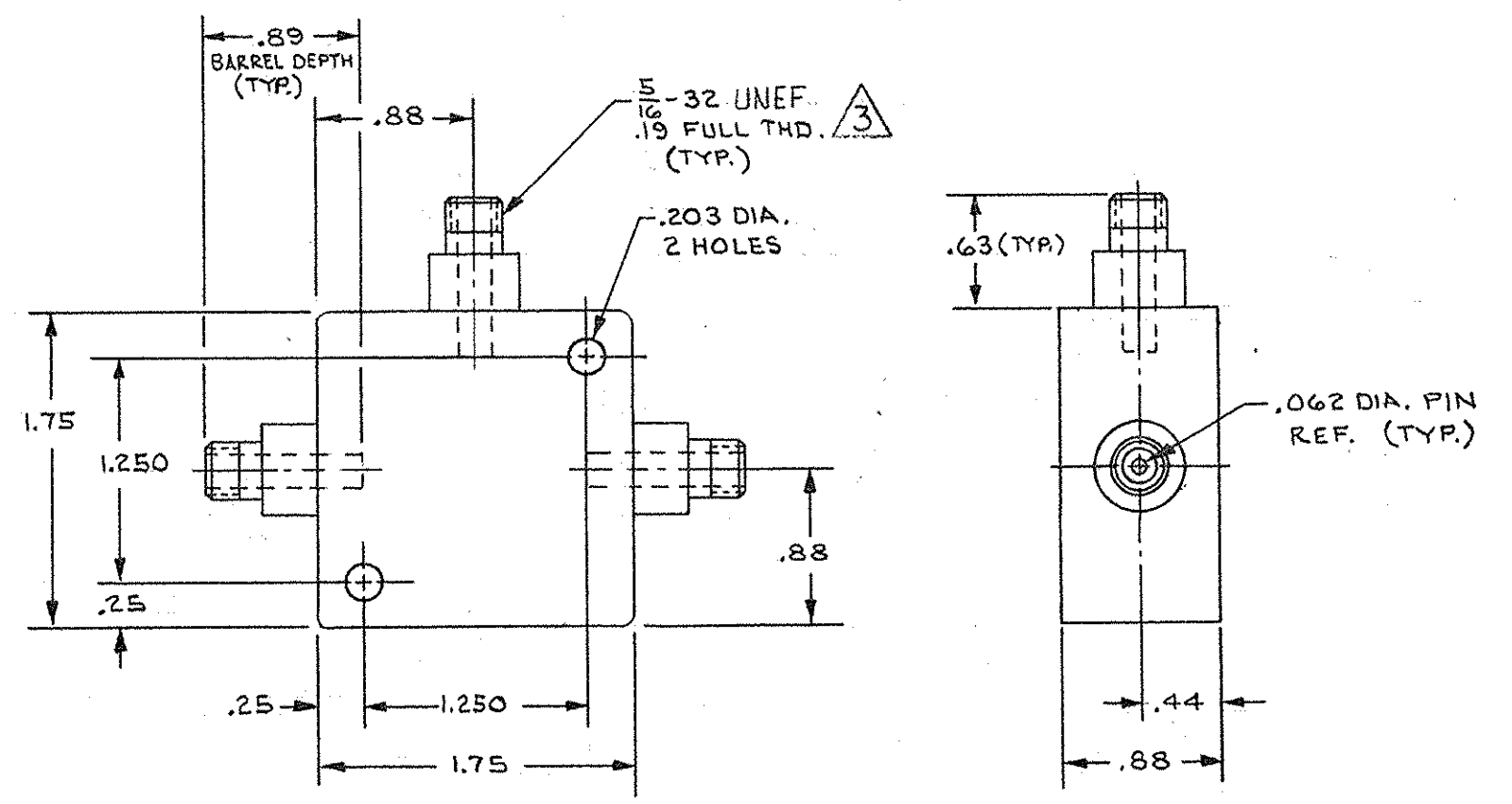

- RECEPTACLE TO MATE WITH AMP LGH- $\frac{1}{2}$ L LEAD ASSEMBLY, AVAILABLE SEPARATELY.
- ALL RECEPTACLE'S ARE COMMON
- PER FEDERAL STANDARD H-28 3 WIRE METHOD. DIMENSION OVER WIRES TO BE: .307-.318.

5-850736-1	RECEPTACLE PINS TIN PLATED
OBS 850736-2	RECEPTACLE, PINS GOLDPLATED
850736-1	RECEPTACLE, PINS TIN-LEAD PLATED

QTY REQD	QTY REQD	ITEM NO.	DWG SIZE	PART OR IDENTIFYING NO.	NOMENCLATURE OR DESCRIPTION
					PARTS LIST

UNLESS OTHERWISE SPECIFIED: DIMENSIONS ARE IN INCHES TOLERANCES .00 ±      ANGLES = .000 ±      ✓		CONTRACT NO. DR <i>W.C. Crabb</i> 9-17-68		AMP INCORPORATED CAPITRON DIVISION ELIZABETHTOWN, PENNSYLVANIA	
MATERIAL: EPOXY		CHK		NAME LGH- $\frac{1}{2}$ L "T" RECEPTACLE	
FINISH: NATURAL		APPD APPD		LGH	
DSGN APPD <i>J.W. Law</i> 9-18 68		SIZE C	CODE IDENT NO. 00779	NUMBER 850736	
OTHER APPD		SCALE 1/4"	WT	SHEET 10/1	

QTY REQD	FINAL ASSY	NEXT ASSY	USED ON	APPLICATION

PRINTED AT 100 DF F 50